

YUNYISONIC

www.yunyisonic.com

Desktop Ultrasonic Cleaner

Instruction Manual >>



Application

Eyeglasses shop, jewelry shop, clocks&watch shop, repair shop, hospital, dental clinics, laboratory, electronic workshop, office and household use.

ULTRASONIC CLEANER

Cautions

- Ensure the power supply is in rated range before power cable is connected. Refitting is strictly prohibited! Attention that the control panel will be corroded by organic solution, strong acid and strong alkali.
- Ensure the earth wiring is well connected before starting.
- Activate key of system should be on position of “ ON/OFF ” button.
- Do not turn on machine if the tank is empty or the transducer will be damaged.
- Please close the lid to reduce noise and pay attention to water and steam in case of burning skin while open the lid.
- Do not relocate the machine when fluid in the tank in case of overflow.
- Water-soluble liquid is suggested for bench top ultrasonic cleaner. Strong acid or flammability cleaner is strictly forbidden. If solvent type cleaner is added in tank, please stop working for a while after 30mins cycle.
- Do not use the machine in below environment.
 - The place where temperature change fiercely
 - The place where vibration or impact is strong
 - The place where water,oil or chemicals splash
 - The place where humidity is too high and is easy to produce dew.
 - The place where exists corrosive gas or dust
 - The place where is filled with explosive and flammable gas

Daily maintenance

- Regular maintenance, electrical control system with high pressure air blow off the dust.
- Clean the tank at least once a week

Trouble clearing

No.	Problems	Possible cause	Solutions
1	No ultrasonic	A.Power supply not connect B.Fuse broken C.Cable short circuit D.Transducer short circuit E.PCB Board broken F.Other reasons	A.Check and plug power switch B.Check the fitted power supply and change the same specification fuse C.Connect fitted cable or replace a new D.Inquiry our after service engineer E.Check the broken part and change it F.Inquiry our after service engineer
2	Not well cleaning	A.Not strong ultrasonic cleaning B.Too high too low liquid surface C.Too high too low temperature D.Not suitable cleaning liquid E.Other reasons	A.Connect ultrasonic button and adjust B.Adjust liquid into the best surface C.Adjust the temperature into the most fitted D.Stop and switch off power supply, replace suitable liquid after previous liquid cool down E.Inquiry our after service engineer
3	Electric leakage	A.Customer side not grounded B.Machine not grounded	A.To ensure grounded B.Check if machine earth wire loosen
4	Other problems		

Product introduction

- ① Lid
- ② Tank
- ③ Stainless steel body
- ④ Plug
- ⑤ Stainless steel basket

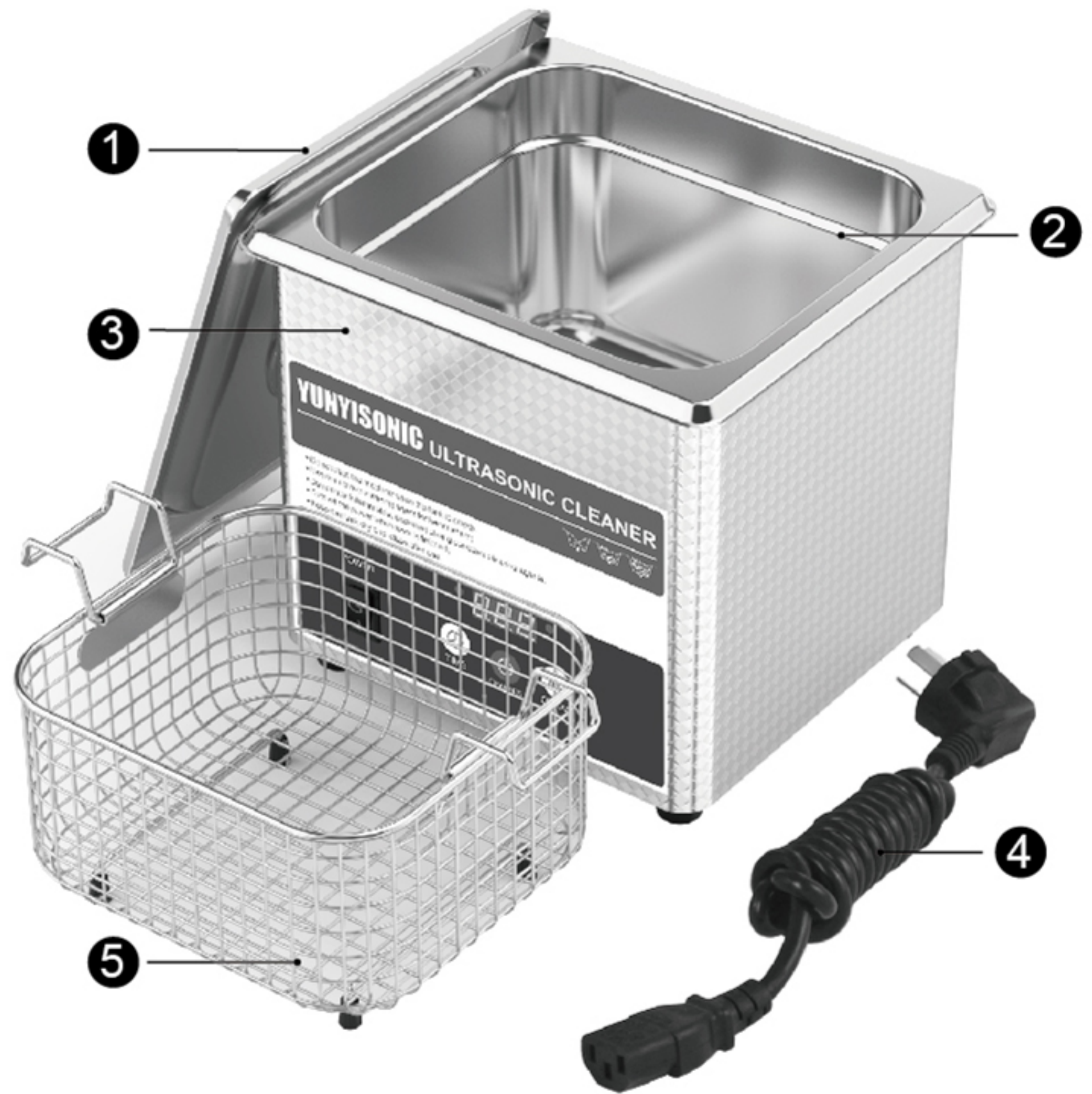

Specifications

Model	Capacity (L)	Frequency (KHz)	Ultrasonic Power (W)	Input voltage	Tank Size (LxWxH mm)	Unit Size (LxWxH mm)
YA008C	0.8	40	35	AC220-240V 50Hz / AC100-120 60Hz	150x85x65	175x110x125
YA008	0.8	40	35		150x85x65	175x110x125
YA008G	0.8	40	60		150x85x65	175x110x125
YA010C	1	40	35		168x94x68	192x118x128
YA010	1	40	35		168x94x68	192x118x128
YA010G	1	40	60		168x94x68	192x118x128
YA013C	1.3	40	35		150x135x65	175x165x125
YA013	1.3	40	35		150x135x65	175x165x125
YA013G	1.3	40	60		150x135x65	175x165x125
YA020C	2	40	35		150x135x100	175x165x160
YA020	2	40	35		150x135x100	175x165x160
YA020G	2	40	60		150x135x100	175x165x160

Operation interface

YA008/G YA010/G YA013/G YA020/G

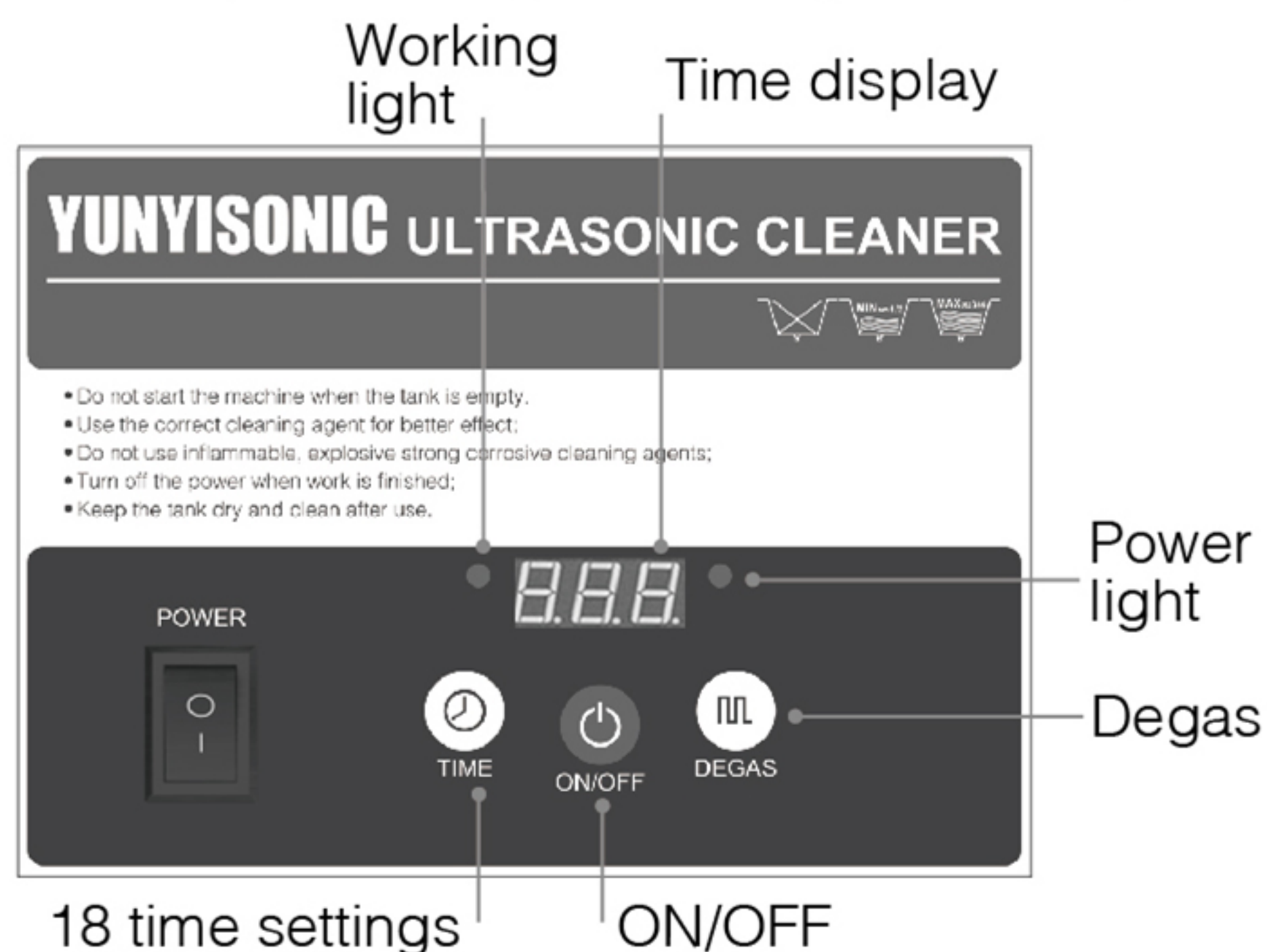

YA008C/YA010C/YA013C/YA020C

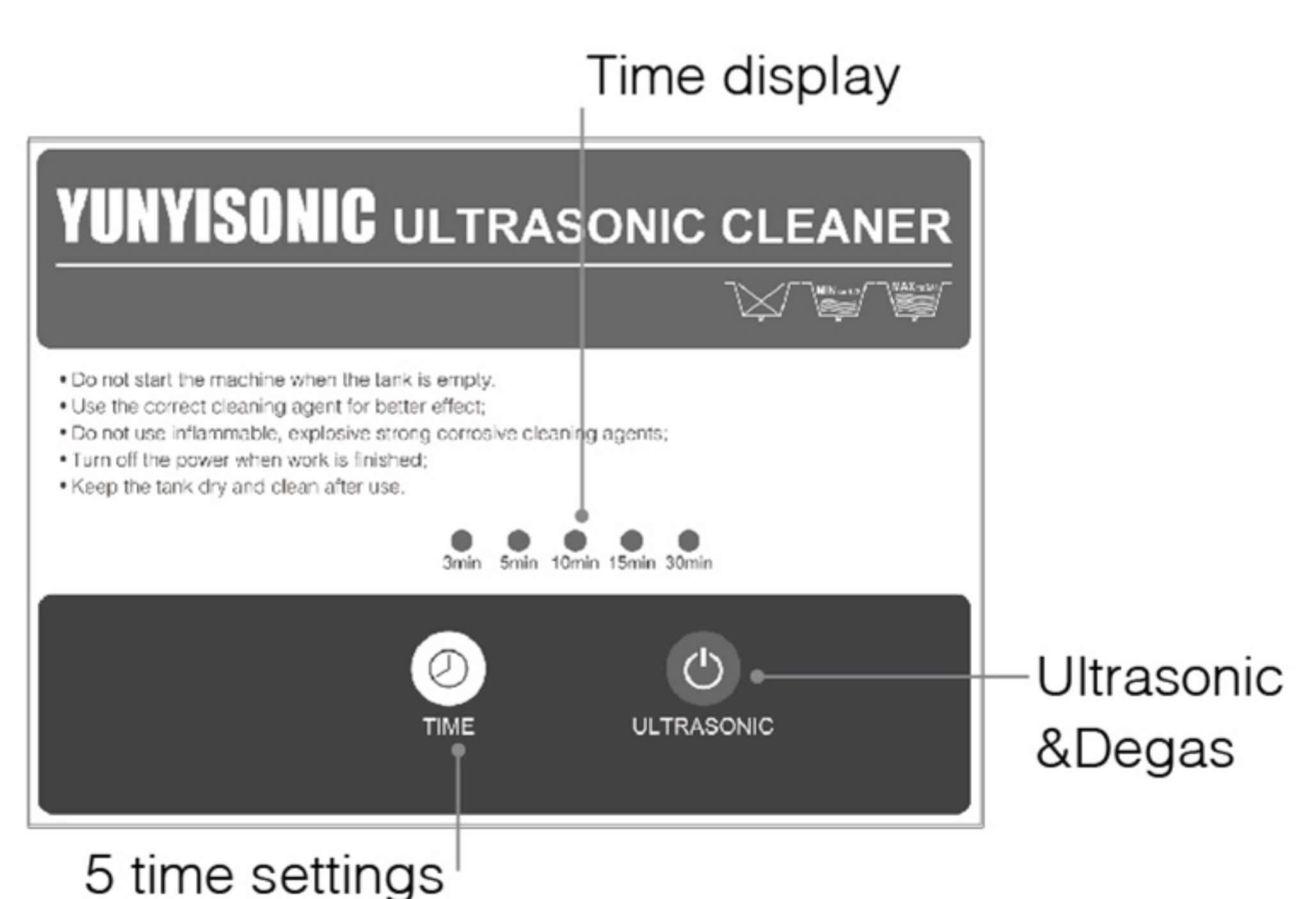

ULTRASONIC CLEANER

YA008/G YA010/G YA013/G YA020/G Operation steps



- 1 Check the machine**
Plug the machine to be sure the machine is power on then press “ POWER ” ,in this case the power indicator lights.
- 2 Uncover the lip and fill the tank with tap water.**
No water operation will damage the machine, please put the cleaning objects in the water. Fully immerse the part to be cleaned in the water, but do not over the MAX line.
- 3 Time setting**
Press “ TIMER ” to choose the amount of time you wish the items to be cleaned. There are 18 times for option 90s 120s 150s 180s 210s 240s 540s 720s 900s 18m 21m 24m 27m 30m.
- 4 Ultrasonic Working**
After timer setted , press "ON/OFF" button, the blue indicator light light , then the countdown starts and device will start work as the setted . Device will automatically stops when the time is zero.
- 5 Degas**
Press “ Degas ” ,the machine will work for 6 seconds and stop for 3 seconds.
- 6 Finish work**
Please do unplug the machine first after working, and then clean the tank. Be sure no liquid is in the tank if need long-term storage.

YA008C YA010C YA013C YA020C Operation steps

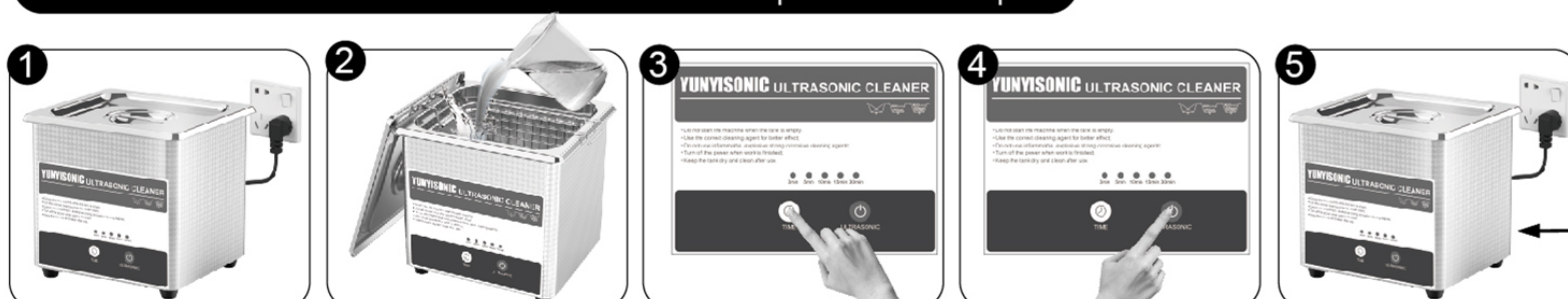

- 1 2 Ditto**
- 3 Time setting**
Each time you press the "TIME" key, the time is cycled through. Select time, 3 /5 /10 /15 /30 minutes of 5 levels.. When the time is selected, the corresponding indicator lights up.
- 4 Ultrasonic work and degas function**
After setting the time, lightly press the "ULTRASONIC", the set blue light flashes and the machine works according to the specified parameters. Time countdown starts, as the time decreases, the flashing indicator will change with the remaining time, the remaining time is zero when the work automatically stops, the indicator lights up back to the set time. During the working process, you can also lightly press the "ULTRASONIC" to stop artificially.
Press the "ULTRASONIC" button 3 times continuously within 3 seconds to enter degassing mode.
- 5 Ditto “ 6 ”**